

Q U7-Pro

Switching

WiFi

Camera Security

Door Access

CloudKeys & Gateways

Power Tech

New I

Flagship > U7 Pro

Datasheet

In The Box

Marketing Images

FAQ

Installation Guide

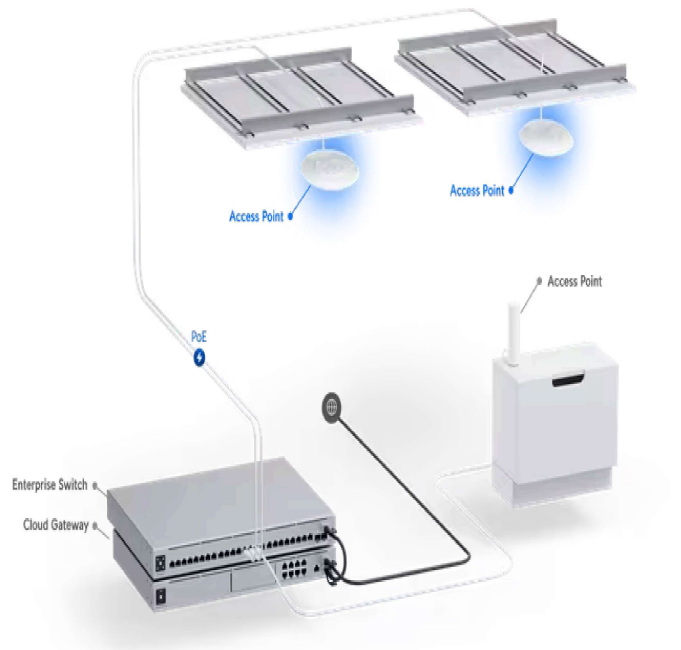
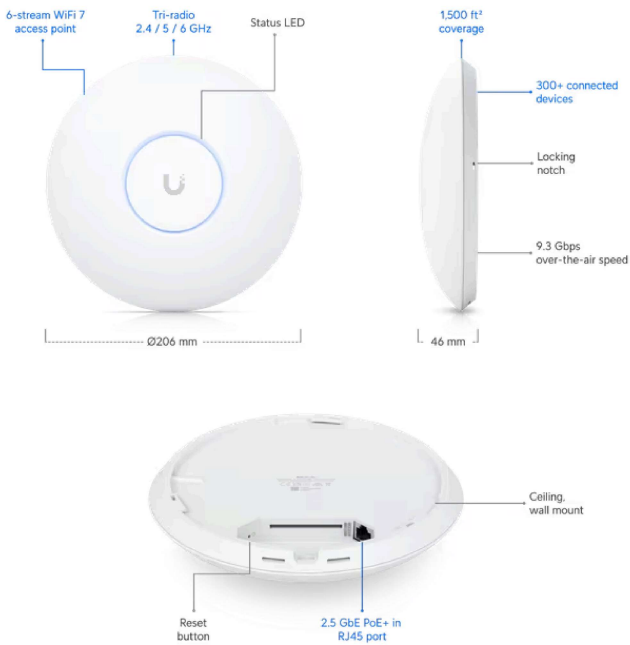

Mechanical

Dimensions Ø206 x 46 mm (Ø8.1 x 1.8")

Weight 680 g (1.5 lb)

Enclosure material Polycarbonate, metal

Mount material Stainless steel (SUS304), galvanized steel (SGCC)

Hardware

Networking interface (1) 1/2.5 GbE RJ45 port

Management interface	Ethernet
Power method	PoE+
Power supply	UniFi PoE switch
Supported voltage range	44—57V DC
Max. power consumption	21W
Max. TX power	
2.4 GHz	22 dBm
5 GHz	26 dBm
6 GHz	23 dBm
MIMO	
2.4 GHz	2 x 2 (DL/UL MU-MIMO)
5 GHz	2 x 2 (DL/UL MU-MIMO)
6 GHz	2 x 2 (DL/UL MU-MIMO)
Max. data rate	
2.4 GHz	688 Mbps (BW40)
5 GHz	4.3 Gbps (BW240)
6 GHz	5.7 Gbps (BW320)
Antenna gain	
2.4 GHz	4 dBi
5 GHz	6 dBi
6 GHz	5.8 dBi
LEDs	White/blue
Button	Factory reset
Mounting	Wall/ceiling (Included)
Ambient operating temperature	-30 to 60° C (-22 to 140° F)
Ambient operating humidity	5 to 95% noncondensing
Certifications	CE, FCC, IC

Software

WiFi standards	802.11a/b/g/n/ac/ax/be (WiFi 6/6E, WiFi 7)
Wireless security	WPA-PSK, WPA-Enterprise (WPA/WPA2/WPA3/PPSK)
BSSID	8 per radio
VLAN	802.1Q
Advanced QoS	Per-user rate limiting

Guest traffic isolation Supported

Concurrent clients 300+

Supported Data Rates

802.11a 6, 9, 12, 18, 24, 36, 48, 54 Mbps

802.11b 1, 2, 5.5, 11 Mbps

802.11g 6, 9, 12, 18, 24, 36, 48, 54 Mbps

802.11n 6.5 Mbps to 300 Mbps (MCS0 - MCS15, HT 20/40)

802.11ac 6.5 Mbps to 1.7 Gbps (MCS0 - MCS9 NSS1/2, VHT 20/40/80/160)

802.11ax (WiFi 6/6E) 7.3 Mbps to 2.4 Gbps (MCS0 - MCS11 NSS1/2, HE 20/40/80/160)

802.11be (WiFi 7) 7.3 Mbps to 5.7 Gbps (MCS0 - MCS13 NSS1/2, EHT 20/40/80/160/240/320)

Application Requirements

UniFi Network Version 8.0.26 and later

UniFi OS Version 3.2 and later

Stay in Touch



[Terms of Service](#) | [Privacy Policy](#) | [Legal](#) | [Cookies Settings](#)

© 2024 Ubiquiti, Inc. All rights reserved.